

FPS ST series

8" Submersible Turbine Pumps



Submersible Turbine Pumps

ST Series

Performance Data:

Discharge Size: 4" and 6" FNPT
Capacity: 225 to 1000 gpm @ B.E.P
HP: 7.5 hp to 125 hp
Head: Up to 1900 ft

Applications:

- Irrigation
- Agriculture
- Industrial
- Municipal
- Commercial

Features:

- 100% Franklin factory wet tested with test results shipped with each pump
- Ductile iron discharge and suction bracket
- Ductile iron bowls bolt together for easy service
- Stainless steel upthrust bolt provides exceptional upthrust protection
- Bronze discharge bearing is grease packed for maximum bearing protection
- Fluted rubber bearings in all bowls
- Suction inlet located above bottom bearing to prevent abrasives from entering the bearing
- Stainless steel impellers with stainless steel taper lock secures impeller to shaft
- Stainless steel pump shaft for increased durability
- 4" and 6" discharge FNPT for 8" turbines



8" Submersible Turbine Family Curve

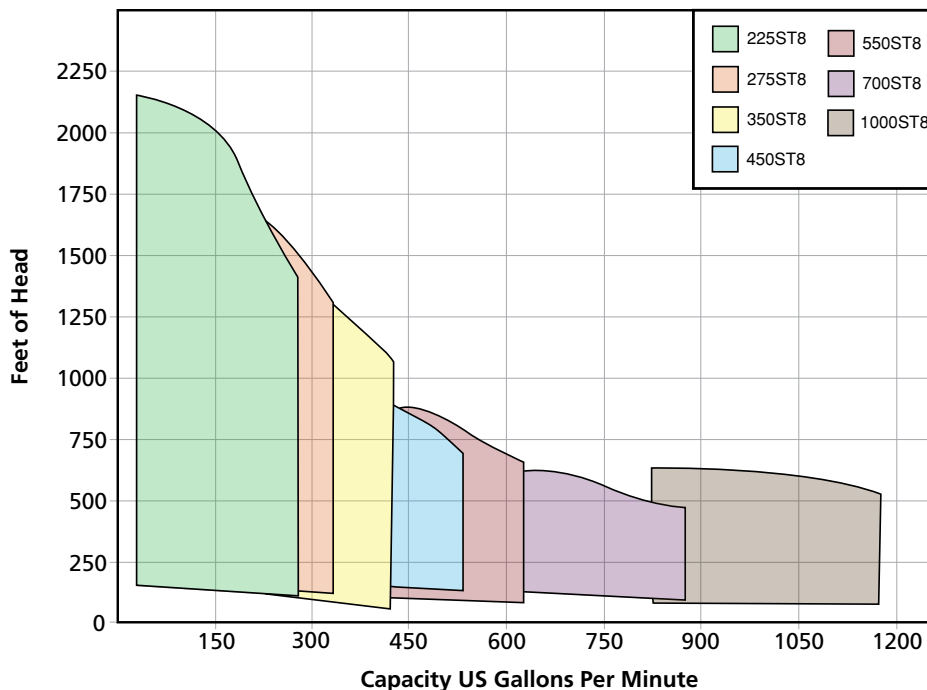

Upthrust Bolt

Protects pump during momentary upthrust at start-up (factory set).

Discharge Bracket

Heavy duty casting with threaded NPT connection, supports grease packed extra long discharge bearing.

Bolting, Fasteners, Cable Guard

Stainless steel for strength and corrosion resistance.

Intermediate Bowl

Heavy duty casting, flanged, supports inter bowl bearing in standard rubber material for reliable, long life. Intermediate bowl epoxy coated for increased efficiency.

Impeller

Enclosed design to optimize efficiency, precision machined taper-lock is designed to ensure locking of impeller to shaft. Impeller is single plane dynamic balanced as standard.

Pump Shaft

Minimum 100,000 psi tensile for maximum strength and corrosion resistance, ground and polished for a smooth bearing surface.

Suction Bracket

Heavy duty casting precision machined to ensure positive motor alignment, contoured for smooth flow entrance and supports standard stainless steel sand collar.

Suction Screen

Stainless steel design is non-collapsible and corrosion resistant.

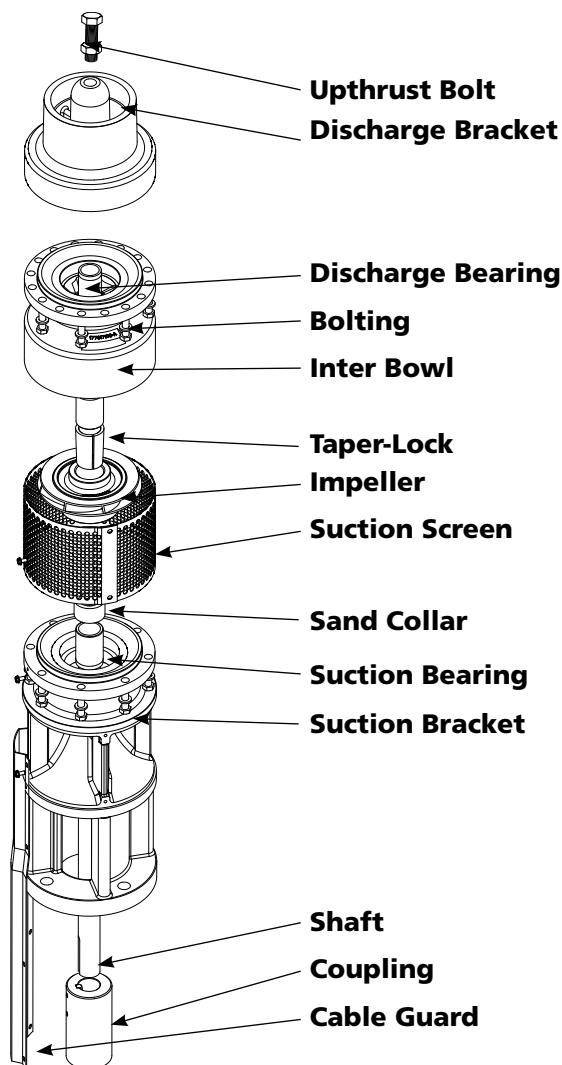

Materials of Construction

Part Name	Common Material Name	Material Spec Number
Discharge Bracket	Ductile Iron	ASTM A536 65-45-12
Top Bowl	Ductile Iron	ASTM A536 65-45-12
Intermediate Bowl	Ductile Iron	ASTM A536 65-45-12
Bearings, Disch. & Suction	Bronze	ASTM 8584 C89835
Impeller	304 Stainless Steel	ASTM A743/A743M CF8
Pump Shaft	416 Stainless Steel	ASTM A582 S41600
Suction Bracket	Ductile Iron	ASTM A536 65-45-12
Bowl Bearing	Rubber	Rubber
Sand Collar	300 Stainless Steel	ASTM A666
Suction Screen	302 Stainless Steel	ASTM A240 S30200
Cable Guard	300 Stainless Steel	ASTM A666
Shaft Coupling	416 Stainless Steel	ASTM A582 S41600
Upthrust Bolt	300 Stainless Steel	ASTM A666
Taper Lock	416 Stainless Steel	ASTM A582 S41600
Bolting	300 Stainless Steel	ASTM A666

Note: Bowl bearing and shaft options available. Refer to catalog for available options.



Franklin Electric

400 East Spring Street, Bluffton, Indiana 46714
Tel: 260.824.2900 Fax: 260.824.2909

www.franklin-electric.com